

GATHERINGS

From corporate meetings to lavish weddings, the tasteful venues of Montage Deer Valley present a compelling array of customizable options for any occasion. We offer more than 25,000 square feet of indoor event space, and more than 35,000 square feet of outdoor function areas.

Meetings & Events Features:

- 4,300-square-foot Grand Ballroom
- 2,750-square-foot Empire Room
- 2,500-square-foot Gallery Ballroom
- Extensive pre-function areas with floor-to-ceiling windows
- 1,100-square-foot Salon
- Executive Boardroom suitable for executive meetings
- 20,000-square-foot Grand Lawn with mountain panoramas
- 4,800-square-foot Mountain Lawn with sunset and valley views
- 5,200-square-foot Grand Terrace
- 2,300-square-foot Gallery Terrace
- 2,000-square-foot Empire Terrace
- Executive business center and event concierge
- 7,000 square feet of dining spaces, including an après-ski terrace, bowling and billiards
- Catering department
- Audio-visual department
- Group transportation
- Local attractions and sightseeing

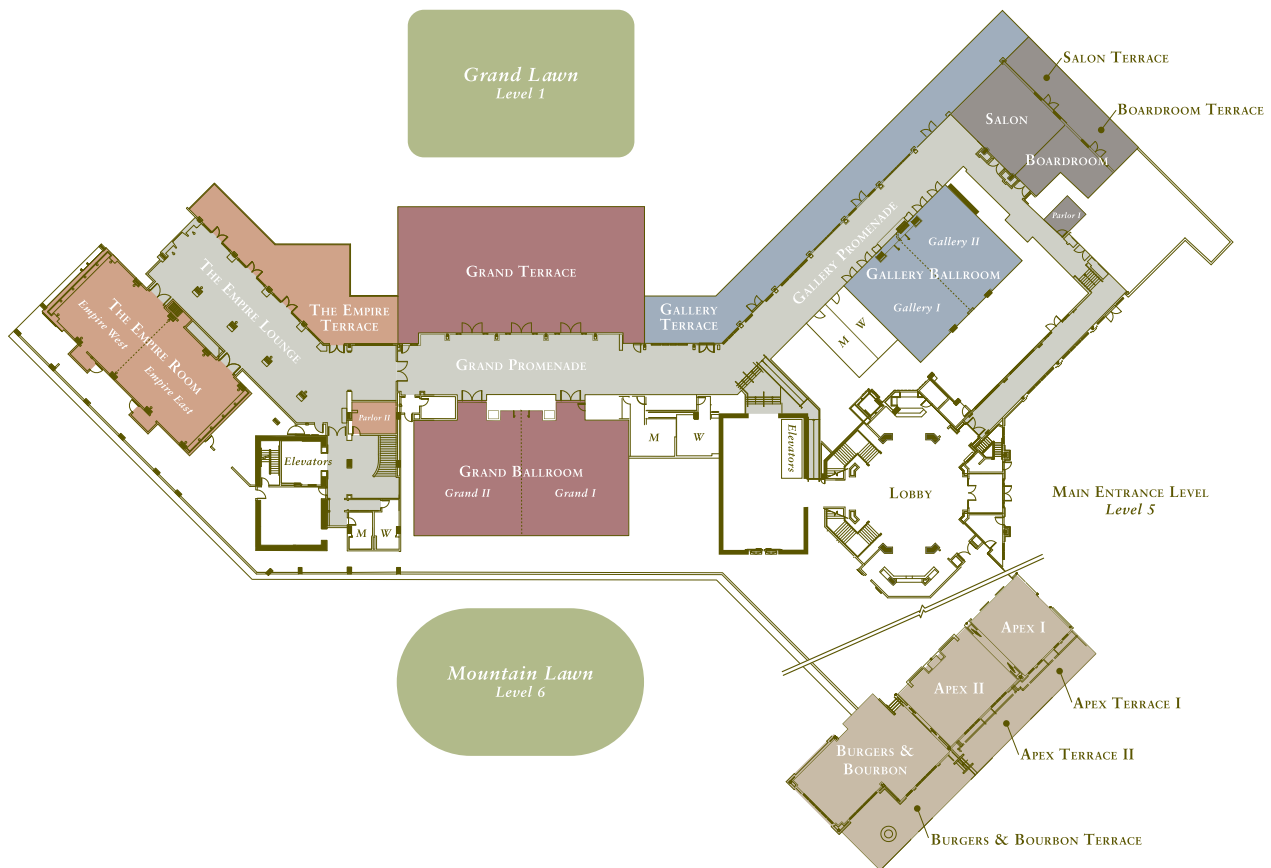

	SQ. FT. (APPROX.)	DIMENSIONS	CEILING	THEATER/ RECEPTION	C/R	RDS. of 10	U/S	CONF	H/S	EXHIBITS (8x10)
INDOOR FUNCTION SPACE										
GRAND BALLROOM	4,300	88' x 48'	16'	450	300	320	100	100	100	25
GRAND I	2,150	44' x 48'	16'	230	140	160	48	50	60	10
GRAND II	2,150	44' x 48'	16'	230	140	160	48	50	60	10
GRAND PROMENADE	3,200	133' x 24'	16'	350	-	180	-	-	-	11
GALLERY BALLROOM	2,500	58' x 43'	12'	250	144	180	57	52	72	13
GALLERY I	1,250	29' x 43'	12'	125	72	90	36	34	42	6
GALLERY II	1,250	29' x 43'	12'	125	72	90	36	34	42	6
GALLERY PROMENADE	2,200	122' x 18'	12'	240	-	100	-	-	-	7
SALON	1,100	36' x 30'	10'	120	70	90	33	32	36	6
BOARDROOM	575	27' x 15'	10'	-	-	-	-	14	-	-
PARLOR	150	15' x 10'	10'	-	-	-	-	8	-	-
PARLOR II	150	15' x 10'	10'	-	-	-	-	4	-	-
THE EMPIRE ROOM	2,750	34' x 81'	12'	280	168	200	72	66	84	12
EMPIRE EAST	1,375	34' x 40'	12'	140	72	100	36	38	48	6
EMPIRE WEST	1,375	34' x 40'	12'	140	72	100	36	38	48	6
THE EMPIRE LOUNGE	3,000	30' x 100'	11'	300	-	150	-	-	-	9
ALPINE SUITE I	550	37' x 15'	10'	40	18	20	12	14	14	-
ALPINE SUITE II	550	37' x 15'	10'	40	18	20	12	14	14	-
OUTDOOR FUNCTION SPACE										
GRAND TERRACE	5,200	100' x 52'	-	450	-	340	-	-	-	-
GALLERY TERRACE	2,300	165' x 14'	-	200	-	120	-	-	-	-
SALON TERRACE	500	36' x 14'	-	40	-	30	-	-	-	-
BOARDROOM TERRACE	450	32' x 14'	-	40	-	20	-	-	-	-
GRAND LAWN	20,000	-	-	2,000	-	1,400	-	-	-	-
MOUNTAIN LAWN	4,800	-	-	450	-	250	-	-	-	-
THE EMPIRE TERRACE	2,000	-	-	150	-	100	-	-	-	-
APEX TERRACE I	400	28' x 15'	-	40	-	20	-	-	-	-
APEX TERRACE II	650	44' x 15'	-	50	-	30	-	-	-	-
BURGERS & BOURBON TERRACE	1,950	-	-	200	-	150	-	-	-	-
DINING										
APEX I & II	2,100	68' x 31'	18'	220	-	120	54	54	60	-
APEX I	800	26' x 31'	18'	80	30	50	21	18	30	-
APEX II	1,300	42' x 31'	18'	110	45	70	33	30	42	-
BURGERS & BOURBON	1,600	52' x 31'	-	100	-	60	-	20	-	-